

HALF FLOOR PLAN
SCALB 1:50

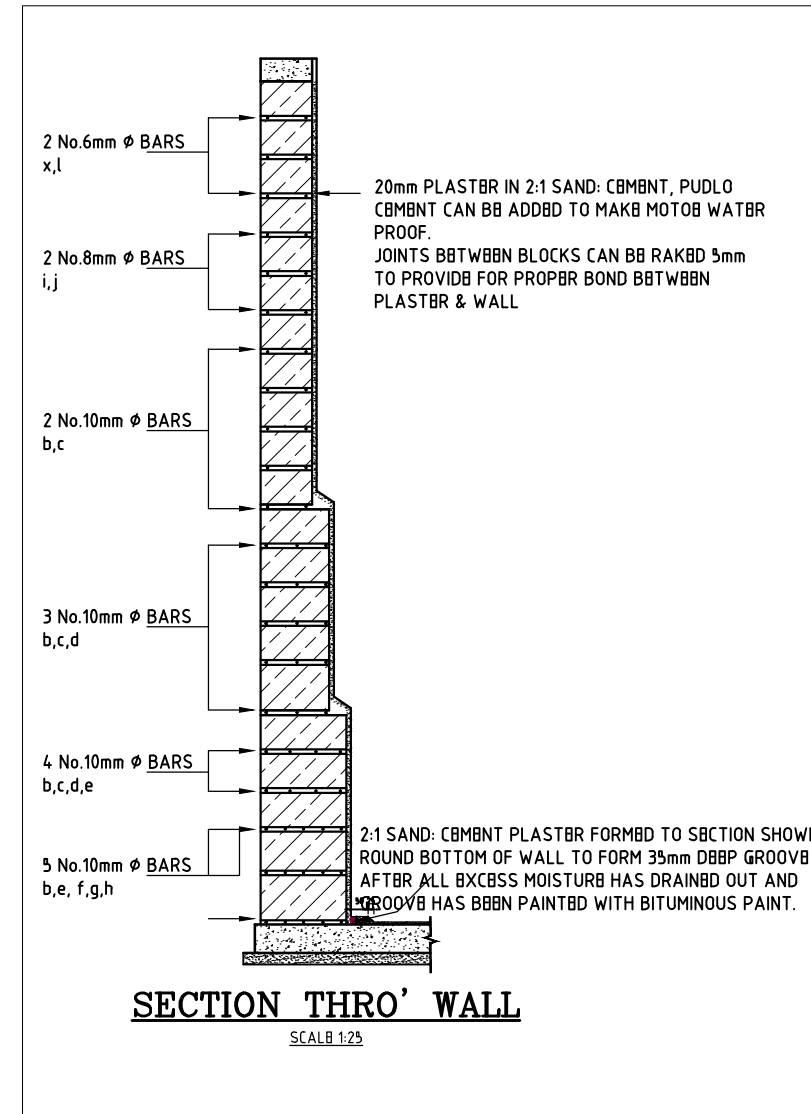

SECTION THRO' WALL
SCALB 1:25

NOTES

1. Read this drawing in conjunction with relevant Plans and section drawings. Any discrepancy to be reported to the Engineer.
2. All dimensions are in Millimeters unless specified otherwise.
3. All levels are indicated in mm unless specified otherwise.
4. All structural concrete to be Class 25 (1:1.5:3) unless stated otherwise.
5. Only figured dimensions to be read, no scaling is allowed on this drawing.
6. Nominal aggregate size to be 20mm.

REV	REVISIONS	SIGN	DATE APPROVED
D	BY	CHECKED	
C	BY	CHECKED	
B	BY	CHECKED	
A	BY	CHECKED	

PROJECT
CONSTRUCTION OF MERTI - KORBESA WATER SUPPLY
Client: Northern Water Services Board (NWSB)
P.o Box 495-70100
Garissa - Kenya

Funding Agency: **GOVERNMENT OF KENYA**
Ministry of Water and Irrigation
P.o Box
Nairobi - Kenya

Project:
STANDARD DRAWINGS
225M3 MASONRY STORAGE TANK

Consultant
Northern Water Services Board (NWSB)
P.o Box 495-70100
Garissa - Kenya

Drawing Title:
225M3 MASONRY STORAGE TANK SECTIONS

Surveyed by G.N. Drawn by J.M.
Checked by G.N. Approved by: Eng. Nderi
Scale: 1:2000 Date: June 2020
Job No. Sheet 2 of 6
DRAWING No. NWSB/EAWS/WI/002